

FOR CONTINUATION REFER SHEET 12-790-134

FOR CONTINUATION REFER SHEET 12-790-135

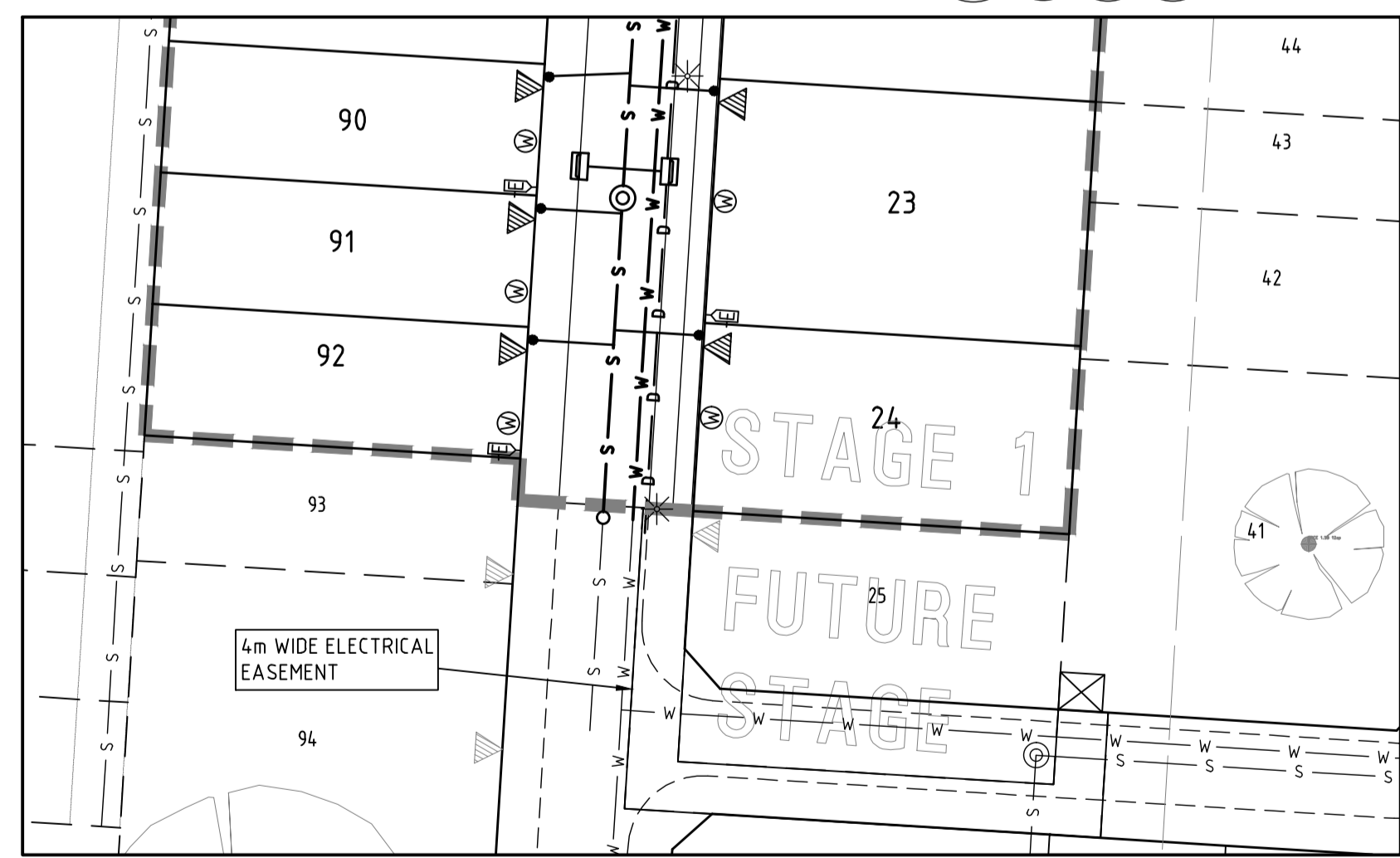

CONTRACTOR SHALL UNDERTAKE NON-DESTRUCTIVE EXCAVATION TECHNIQUES FOR TRENCHING SEWER WITHIN TREE PROTECTION ZONE (HOLD POINT) AND LIAISE WITH COUNCIL ARBORIST TO INSPECT SITE. CONTRACTOR SHALL ALSO ALLOW FOR NON-DESTRUCTIVE EXCAVATION TO WATER DRAINAGE AND COMMON SERVICES TRENCH, TO BE CONFIRMED WITH COUNCIL PENDING OUTCOME OF SEWER TRENCHING



INSET

FOR CONTINUATION REFER INSET (LEFT)

FOR LEGEND REFER SHEET 12-790-134

REVISION	DATE	DESCRIPTION	DESIGN	DRAWN	APPROVED
6	31.03.15	LOT 118 SERVICES AMENDED	CH	JM	
5	26.03.15	ROAD 5 LIMIT OF WORKS AMENDED	CH	JM	
4	6.03.15	STAGE BOUNDARY AMENDED, LOTS 107 TO 118 ADDED	CH	CH	
3	20.02.15	LOTS 631 TO 639 ADDED	CH	JJM	JE
2	28.01.15	REAR OF LOT SEWER REMOVED AND DRAINAGE AMENDED	CH	CH	JE
1	18.12.14	LOTS AMENDED	CH	JJM	JE
0	14.11.14	CONSTRUCTION ISSUE	CH	CH	JE



KEY PLAN

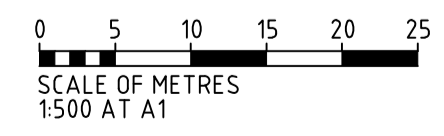

DESIGN	CH	DESIGN CHECK	MB
DRAWN	JM	DRAFTING CHECK	MB
APPROVED	JE	DATE	NOV 2014
CAD FILE: 12-790-136			
THIS DRAWING REMAINS THE PROPERTY OF GREENHILL ENGINEERS PTY LTD AND MAY NOT BE COPIED IN ANY WAY WITHOUT PRIOR APPROVAL FROM THIS COMPANY. © GREENHILL ENGINEERS PTY LTD			

GREENHILL
 Level 1, 64 Hindmarsh Square
 Adelaide SA 5000
 T: 08 8406 1300
 F: 08 8215 0018
 ABN 39 061 222 964



MARTIN ROAD DEVELOPMENTS PTY LTD
 SPRINGLAKE - PHASE 1, STAGE 1
 LOTS 50 AND 51 MARTIN ROAD, MOUNT BARKER
STAGE 1
SERVICES LAYOUT PLAN
SHEET 3 OF 3
 DRAWING NUMBER
12-790-136

REVISION
6

100 MILLIMETRES ON ORIGINAL DRAWING